

FACILITIES ON BOARD

WHAT TO BRING

- 20 private cabins
- 7 hot showers
- 7 toilets
- Fully air conditioned
- Large comfortable saloon
- Flat screen tv
- Hot deck spa
- SCUBA diving
- Snorkelling gear
- Dive board
- 2 on board water slides!

- BYO alcohol/drinks
- Swimwear & beach towel
- Sunscreen
- Sunglasses & hat
- Thongs/sandals
- Light clothing
- Weather proof jacket
- Camera
- Lots of fun and... a sense of humour!

The Whitsunday Islands



Cruising Course

The Whitsundays is situated in the World Heritage listed Great Barrier Reef Marine Park.

ATLANTIC CLIPPER

2 DAYS 2 NIGHTS WHITSUNDAY SAILING

Have the time of your life!



Fly down the 9 metre water slide!



Relax and enjoy the sunshine.



Splash around in the on board spa!



Create memories of a lifetime.



ATLANTIC CLIPPER THE MOST SPACIOUS VESSEL

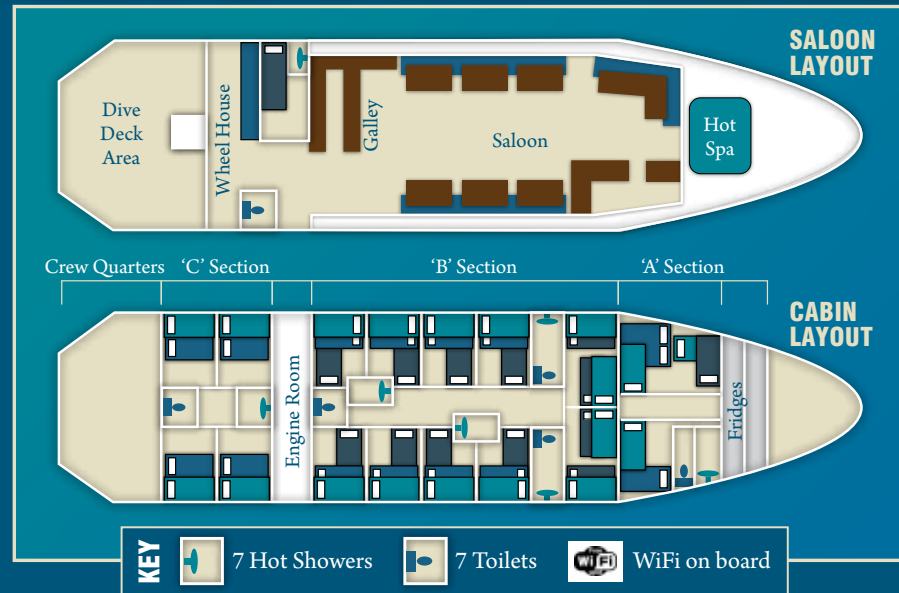

KEY 7 Hot Showers 7 Toilets WiFi on board

VESSEL LENGTH 34M | CREW 6 | MAX PAX 54 | CABINS 20



YUMMY MENU!

BREAKFAST
Fresh breads served with a selection of spreads, tropical fresh fruit platter, toasted muesli, cornflakes, tea & coffee.

LUNCH
Selection of cold meats – shaved Champagne honey ham & roast beef, tuna salad pasta, a selection of salads, cheeses, homemade coleslaw, rolls & wraps.

DINNER
Oven baked Hake with a herb butter sauce served with creamy mash, coleslaw and fresh Aussie damper.
Spaghetti bolognese served with mixed green salad & garlic bread.

SNACKS
Fruit platter, fruit cake, biscuits, chips, dips, American hot dogs (on the last day).
Soft drinks & chips (available for purchase on board)

With prior arrangement, most special diets can be catered for.

BOOK NOW

ABC TRAVEL
Shop 344 Shute Harbour Rd
Airlie Beach Qld 4802
or for more information
phone us or visit our website
07 4946 5755
truebluesailing.com.au

TERMS & CONDITIONS

All meals, snorkel equipment, stinger suits and fresh linen are inclusive in the cost. SCUBA Diving is optional and fees are paid on board. **Itineraries:** Atlantic Clipper reserves the right to change routes or vessels at any time without notice. All itineraries, activities and departures are subject to weather and may be changed or cancelled at the discretion of Atlantic Clipper. It should be noted that adventure sailing includes risks. Whilst we make every effort to safeguard clients, we cannot be held responsible for personal injury or loss due to actions beyond our control. **Travel Insurance:** We recommend that all clients have travel insurance covering illness, injury, loss or damage to personal belongings. Clients cancellations made less than 14 days prior to departure will result in complete forfeiture of the full price paid, and transfer fees do apply. **Client Cancellations:** Client Cancellations from 30 to 60 days of departure will result in loss of 25% of ticket price; 29 to 14 days before departure loss of 50% of ticket price, 14 days to 72 hours before departure 100% charges apply. Transfer fees apply. Minimum 72 hours for a change of date. **Passengers are encouraged to check in the day prior to departure 11:30am-5pm or the morning of departure before 11am at ABC Travel.**



EXPERIENCE PARADISE!

Chill Out in our air conditioned spacious cabins.



PLAY ON ATLANTIC CLIPPER!

Bush Walk along the National Park track to reach the stunning views of Hill Inlet lookout & Whitehaven.



Sunbathe and relax in the beautiful Whitsundays white sandy beaches.



Snorkel amongst the spectacular marine life around the Whitsunday Islands fringing reefs.



Explore the many fun activities on board: fly down the 7 metre waterslide, jump off the dive platform, relax in the spa, catch a movie or ultimately, take a scuba dive and experience the best of the Great Barrier Reef.



Scuba Dive down deep - whether you're certified or have never dived before, you'll love getting down with the fish!



Friends made for life, memories created forever!